

# 1HB77

## Male Hammer Union - 90° Wing Nut

FIG 1502

| #<br>Part Number | Hose I.D.<br>inch | A    |       | B    |       |
|------------------|-------------------|------|-------|------|-------|
|                  |                   | inch | mm    | inch | mm    |
| 1HB77-32-32      | 2                 | 7.59 | 192,9 | 4.84 | 123,0 |

**WARNING:** This product can expose you to chemicals including Lead, which is known to the State of California to cause cancer and birth defects or other reproductive harm. For more information go to [www.p65warnings.ca.gov](http://www.p65warnings.ca.gov).

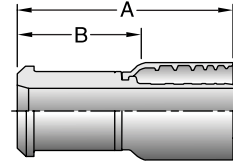

# 1HE77

## Male Hammer Union

FIG 1502

| #<br>Part Number | Hose I.D.<br>inch | A    |       | B    |       |
|------------------|-------------------|------|-------|------|-------|
|                  |                   | inch | mm    | inch | mm    |
| 1HE77-32-32      | 2                 | 7.60 | 192,9 | 4.84 | 123,0 |

**WARNING:** This product can expose you to chemicals including Lead, which is known to the State of California to cause cancer and birth defects or other reproductive harm. For more information go to [www.p65warnings.ca.gov](http://www.p65warnings.ca.gov).

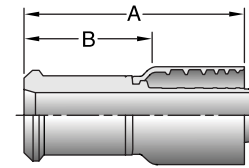

# 1HN77

## Female Hammer Union

FIG 1502

| #<br>Part Number | Thread<br>inch | Hose I.D.<br>inch | A    |       | B    |       |
|------------------|----------------|-------------------|------|-------|------|-------|
|                  |                |                   | inch | mm    | inch | mm    |
| 1HN77-32-32      | 4-1/8x3        | 2                 | 6.95 | 176,4 | 4.19 | 106,5 |

**WARNING:** This product can expose you to chemicals including Lead, which is known to the State of California to cause cancer and birth defects or other reproductive harm. For more information go to [www.p65warnings.ca.gov](http://www.p65warnings.ca.gov).

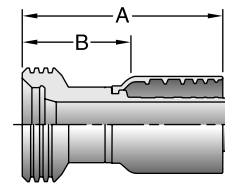

# 10377

## Male JIC 37° - Rigid

| #<br>Part Number | Thread<br>inch | Hose I.D.<br>inch | A    |       | H<br>mm | B    |      |
|------------------|----------------|-------------------|------|-------|---------|------|------|
|                  |                |                   | inch | mm    |         | inch | mm   |
| 10377-8-8        | 1/2 3/4x16     | 1/2               | 2.61 | 66,4  | 22      | 1.39 | 35,4 |
| 10377-10-8       | 5/8 7/8x14     | 1/2               | 2.71 | 68,9  | 24      | 1.49 | 37,9 |
| 10377-10-10      | 5/8 7/8x14     | 5/8               | 3.01 | 76,4  | 24      | 1.66 | 42,2 |
| 10377-12-10      | 3/4 1-1/16x12  | 5/8               | 3.22 | 81,8  | 30      | 1.87 | 47,5 |
| 10377-12-12      | 3/4 1-1/16x12  | 3/4               | 3.53 | 89,6  | 30      | 1.89 | 48,1 |
| 10377-12-16      | 3/4 1-1/16x12  | 1                 | 3.94 | 100,0 | 36      | 1.99 | 50,6 |
| 10377-16-12      | 1 1-5/16x12    | 3/4               | 3.69 | 93,6  | 36      | 2.05 | 52,2 |
| 10377-16-16      | 1 1-5/16x12    | 1                 | 3.99 | 101,3 | 36      | 2.04 | 51,8 |
| 10377-20-16      | 1-1/4 1-5/8x12 | 1                 | 4.33 | 109,9 | 50      | 2.38 | 60,5 |
| 10377-20-20      | 1-1/4 1-5/8x12 | 1-1/4             | 4.66 | 118,4 | 50      | 2.39 | 60,7 |
| 10377-24-24      | 1-1/2 1-7/8x12 | 1-1/2             | 4.93 | 125,2 | 50      | 2.54 | 64,5 |
| 10377-32-32      | 2 2-1/2x12     | 2                 | 5.83 | 148,0 | 65      | 3.07 | 78,0 |

**WARNING:** This product can expose you to chemicals including Lead, which is known to the State of California to cause cancer and birth defects or other reproductive harm. For more information go to [www.p65warnings.ca.gov](http://www.p65warnings.ca.gov).

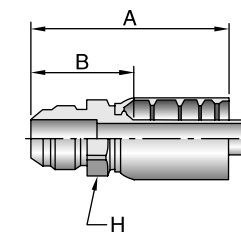

See Accessories Section for O-Rings and Flange Kits.

**Refer to Pressure Rating of Hose End Connections Chart on page E-47.**

# 10677

## Female JIC 37° - Swivel

### ISO 12151-5

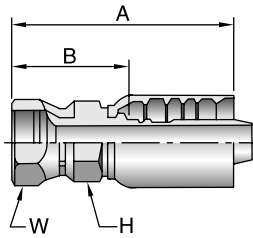

| #<br>Part Number | Thread<br>inch | Hose I.D.<br>inch | A     |      | H     | W  | B    |      |      |
|------------------|----------------|-------------------|-------|------|-------|----|------|------|------|
|                  |                |                   | inch  | mm   | mm    | mm | inch | mm   |      |
| 10677-6-8        | 3/8            | 9/16x18           | 1/2   | 2.75 | 69,7  | 22 | 19   | 1.53 | 38,8 |
| 10677-6-8C       | 3/8            | 9/16x18           | 1/2   | 2.75 | 69,7  | 22 | 19   | 1.53 | 38,8 |
| 10677-8-8        | 1/2            | 3/4x16            | 1/2   | 2.79 | 71,1  | 22 | 22   | 1.58 | 40,1 |
| 10677-8-8C       | 1/2            | 3/4x16            | 1/2   | 2.79 | 71,1  | 22 | 22   | 1.58 | 40,1 |
| 10677-10-8       | 5/8            | 7/8x14            | 1/2   | 2.91 | 74,0  | 22 | 27   | 1.69 | 43,0 |
| 10677-10-10      | 5/8            | 7/8x14            | 5/8   | 3.18 | 80,7  | 24 | 27   | 1.83 | 46,5 |
| 10677-10-10C     | 5/8            | 7/8x14            | 5/8   | 3.18 | 80,7  | 24 | 27   | 1.83 | 46,5 |
| 10677-10-12      | 5/8            | 7/8x14            | 3/4   | 3.62 | 91,8  | 30 | 27   | 1.98 | 50,3 |
| 10677-12-8       | 3/4            | 1-1/16x12         | 1/2   | 3.17 | 80,4  | 30 | 32   | 1.95 | 49,5 |
| 10677-12-10      | 3/4            | 1-1/16x12         | 5/8   | 3.30 | 83,9  | 30 | 32   | 1.95 | 49,6 |
| 10677-12-12      | 3/4            | 1-1/16x12         | 3/4   | 3.68 | 93,5  | 30 | 32   | 2.05 | 52,0 |
| 10677-12-12C     | 3/4            | 1-1/16x12         | 3/4   | 3.77 | 95,7  | 30 | 36   | 2.13 | 54,2 |
| 10677-12-16      | 3/4            | 1-1/16x12         | 1     | 4.12 | 104,7 | 36 | 32   | 2.17 | 55,2 |
| 10677-14-12      | 7/8            | 1-3/16x12         | 3/4   | 3.88 | 98,5  | 36 | 36   | 2.24 | 56,9 |
| 10677-16-12      | 1              | 1-5/16x12         | 3/4   | 3.89 | 98,7  | 36 | 41   | 2.25 | 57,3 |
| 10677-16-12C     | 1              | 1-5/16x12         | 3/4   | 4.01 | 101,8 | 36 | 46   | 2.37 | 60,3 |
| 10677-16-16      | 1              | 1-5/16x12         | 1     | 4.16 | 105,7 | 36 | 41   | 2.21 | 56,2 |
| 10677-16-16C     | 1              | 1-5/16x12         | 1     | 4.16 | 105,7 | 36 | 41   | 2.21 | 56,2 |
| 10677-16-20      | 1              | 1-5/16x12         | 1-1/4 | 4.84 | 123,0 | 46 | 41   | 2.57 | 65,3 |
| 10677-20-16      | 1-1/4          | 1-5/8x12          | 1     | 4.29 | 109,1 | 41 | 50   | 2.34 | 59,5 |
| 10677-20-20      | 1-1/4          | 1-5/8x12          | 1-1/4 | 4.86 | 123,5 | 46 | 50   | 2.59 | 65,8 |
| 10677-20-20C     | 1-1/4          | 1-5/8x12          | 1-1/4 | 4.92 | 125,0 | 46 | 60   | 2.65 | 67,3 |
| 10677-24-20      | 1-1/2          | 1-7/8x12          | 1-1/4 | 4.98 | 126,5 | 50 | 60   | 2.71 | 68,6 |
| 10677-24-24      | 1-1/2          | 1-7/8x12          | 1-1/2 | 5.34 | 135,7 | 50 | 60   | 2.95 | 75,0 |
| 10677-24-24C     | 1-1/2          | 1-7/8x12          | 1-1/2 | 5.55 | 140,9 | 50 | 65   | 3.16 | 80,3 |
| 10677-32-32      | 2              | 2-1/2x12          | 2     | 6.29 | 159,8 | 65 | 75   | 3.54 | 89,9 |
| 10677-32-32C*    | 2              | 2-1/2x12          | 2     | 6.29 | 159,8 | 65 | 75   | 3.54 | 89,9 |

All sizes of 10677 fittings are rated at 5,000 psi working pressure.

"C" suffix indicates stainless steel part. Some stainless steel parts are dimensionally different than the standard part.

\*This specific size in stainless is not able to be crimped in any Parkrimp machine.

**WARNING:** This product can expose you to chemicals including Lead, which is known to the State of California to cause cancer and birth defects or other reproductive harm. For more information go to [www.p65warnings.ca.gov](http://www.p65warnings.ca.gov).

See Accessories Section for O-Rings and Flange Kits.

 Refer to Pressure Rating of Hose End Connections Chart on page E-47.

# 13777

## Female JIC 37° - Swivel - 45° Elbow - Short Drop

ISO 12151-5

| #<br>Part Number | Thread |           | Hose I.D.<br>inch | A    |       | E    |    | W<br>mm | B    |       |
|------------------|--------|-----------|-------------------|------|-------|------|----|---------|------|-------|
|                  | inch   | 3/4x16    |                   | inch | mm    | inch | mm |         | inch | mm    |
| 13777-8-8        | 1/2    | 3/4x16    | 1/2               | 2.86 | 72,7  | 0.59 | 15 | 22      | 1.64 | 41,8  |
| 13777-8-8C       | 1/2    | 3/4x16    | 1/2               | 2.86 | 72,7  | 0.59 | 15 | 22      | 1.64 | 41,8  |
| 13777-10-8       | 5/8    | 7/8x14    | 1/2               | 3.06 | 77,8  | 0.63 | 16 | 27      | 1.84 | 46,8  |
| 13777-10-10      | 5/8    | 7/8x14    | 5/8               | 3.40 | 86,3  | 0.63 | 16 | 27      | 2.05 | 52,1  |
| 13777-12-12      | 3/4    | 1-1/16x12 | 3/4               | 4.37 | 110,9 | 0.83 | 21 | 32      | 2.73 | 69,4  |
| 13777-12-12C     | 3/4    | 1-1/16x12 | 3/4               | 4.37 | 110,9 | 0.83 | 21 | 32      | 2.73 | 69,4  |
| 13777-16-12      | 1      | 1-5/16x12 | 3/4               | 4.49 | 114,0 | 0.94 | 24 | 41      | 2.85 | 72,5  |
| 13777-16-16      | 1      | 1-5/16x12 | 1                 | 4.79 | 121,7 | 0.94 | 24 | 41      | 2.84 | 72,2  |
| 13777-20-20      | 1-1/4  | 1-5/8x12  | 1-1/4             | 6.42 | 163,1 | 1.26 | 32 | 50      | 4.15 | 105,4 |
| 13777-32-32*     | 2      | 2-1/2x12  | 2                 | 8.58 | 218,0 | 2.20 | 56 | 75      | 5.83 | 148,1 |

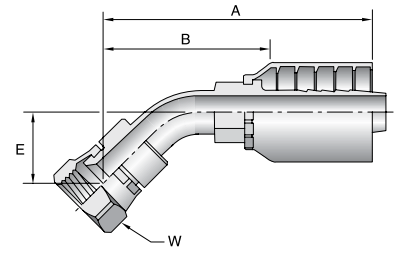

All sizes of 13777 fittings are rated at 5,000 psi working pressure.

"C" suffix indicates stainless steel part. Some stainless steel parts are dimensionally different than the standard part.

\*This specific size is not able to be crimped in any Parkrimp machine.

**WARNING:** This product can expose you to chemicals including Lead, which is known to the State of California to cause cancer and birth defects or other reproductive harm. For more information go to [www.p65warnings.ca.gov](http://www.p65warnings.ca.gov).

# 13977

## Female JIC 37° - Swivel - 90° Elbow - Short Drop

ISO 12151-5

| #<br>Part Number | Thread |           | Hose I.D.<br>inch | A    |       | E    |       | W<br>mm | B    |       |
|------------------|--------|-----------|-------------------|------|-------|------|-------|---------|------|-------|
|                  | inch   | 3/4x16    |                   | inch | mm    | inch | mm    |         | inch | mm    |
| 13977-8-8        | 1/2    | 3/4x16    | 1/2               | 2.78 | 70,7  | 1.14 | 29,0  | 22      | 1.56 | 39,7  |
| 13977-8-8C       | 1/2    | 3/4x16    | 1/2               | 2.78 | 70,7  | 1.14 | 29,0  | 22      | 1.56 | 39,7  |
| 13977-10-8       | 5/8    | 7/8x14    | 1/2               | 2.77 | 70,5  | 1.26 | 32,0  | 27      | 1.55 | 39,5  |
| 13977-10-10      | 5/8    | 7/8x14    | 5/8               | 3.21 | 81,5  | 1.26 | 32,0  | 27      | 1.86 | 47,3  |
| 13977-12-10      | 3/4    | 1-1/16x12 | 5/8               | 3.21 | 81,5  | 1.89 | 48,0  | 32      | 1.86 | 47,3  |
| 13977-12-12      | 3/4    | 1-1/16x12 | 3/4               | 4.23 | 107,4 | 1.89 | 48,0  | 32      | 2.60 | 66,0  |
| 13977-12-12C     | 3/4    | 1-1/16x12 | 3/4               | 4.23 | 107,4 | 1.89 | 48,0  | 32      | 2.60 | 66,0  |
| 13977-16-12      | 1      | 1-5/16x12 | 3/4               | 4.23 | 107,4 | 2.93 | 74,5  | 41      | 2.59 | 65,9  |
| 13977-16-16      | 1      | 1-5/16x12 | 1                 | 4.72 | 119,9 | 2.93 | 74,4  | 41      | 2.77 | 70,4  |
| 13977-16-16C     | 1      | 1-5/16x12 | 1                 | 4.72 | 119,9 | 2.93 | 74,4  | 46      | 2.77 | 70,4  |
| 13977-20-20      | 1-1/4  | 1-5/8x12  | 1-1/4             | 6.28 | 159,5 | 3.07 | 78,0  | 50      | 4.01 | 101,8 |
| 13977-20-20C     | 1-1/4  | 1-5/8x12  | 1-1/4             | 6.28 | 159,5 | 3.07 | 78,0  | 60      | 4.01 | 101,8 |
| 13977-24-24      | 1-1/2  | 1-7/8x12  | 1-1/2             | 7.24 | 183,9 | 3.74 | 95,0  | 60      | 4.85 | 123,2 |
| 13977-32-32      | 2      | 2-1/2x12  | 2                 | 8.75 | 222,1 | 5.51 | 140,0 | 75      | 5.99 | 152,2 |

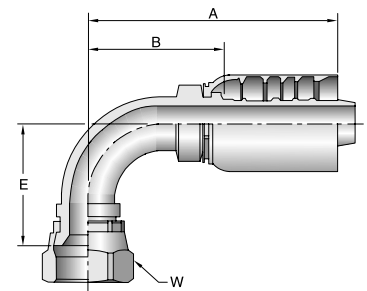

All sizes of 13977 fittings are rated at 5,000 psi working pressure.

"C" suffix indicates stainless steel part. Some stainless steel parts are dimensionally different than the standard part.

**WARNING:** This product can expose you to chemicals including Lead, which is known to the State of California to cause cancer and birth defects or other reproductive harm. For more information go to [www.p65warnings.ca.gov](http://www.p65warnings.ca.gov).

See Accessories Section for O-Rings and Flange Kits.

**Refer to Pressure Rating of Hose End Connections Chart on page E-47.**

# 14177

## Female JIC 37° - Swivel - 90° Elbow - Long Drop

ISO 12151-5

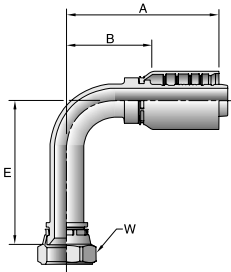

| #<br>Part Number | Thread |           | Hose I.D.<br>inch | A    |       | E    |       | W<br>mm | B    |      | Additional Material<br>Stainless Steel (C) |
|------------------|--------|-----------|-------------------|------|-------|------|-------|---------|------|------|--|
|                  | inch   |           |                   | inch | mm    | inch | mm    |         | inch | mm   |  |
| 14177-8-8        | 1/2    | 3/4x16    | 1/2               | 2.78 | 70,7  | 2.52 | 64,0  | 22      | 1.56 | 39,7 | ●  |
| 14177-12-12      | 3/4    | 1-1/16x12 | 3/4               | 4.24 | 107,6 | 3.78 | 96,0  | 32      | 2.60 | 66,1 |  |
| 14177-16-16      | 1      | 1-5/16x12 | 1                 | 4.72 | 119,9 | 4.49 | 114,0 | 41      | 2.77 | 70,4 |  |

All sizes of 14177 fittings are rated at 5,000 psi working pressure.

**WARNING:** This product can expose you to chemicals including Lead, which is known to the State of California to cause cancer and birth defects or other reproductive harm. For more information go to [www.p65warnings.ca.gov](http://www.p65warnings.ca.gov).

# 10577

## Male SAE Thread with O-Ring - Rigid

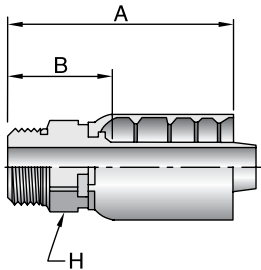

| #<br>Part Number | Thread |           | Hose I.D.<br>inch | A    |       | H<br>mm | B    |      | Additional Material<br>Stainless Steel (C) |
|------------------|--------|-----------|-------------------|------|-------|---------|------|------|--|
|                  | inch   |           |                   | inch | mm    |         | inch | mm   |  |
| 10577-8-8        | 1/2    | 3/4x16    | 1/2               | 2.39 | 60,8  | 22      | 1.17 | 29,8 | ●  |
| 10577-12-12      | 3/4    | 1-1/16x12 | 3/4               | 3.17 | 80,5  | 32      | 1.53 | 38,9 | ●  |
| 10577-16-16      | 1      | 1-5/16x12 | 1                 | 3.73 | 94,7  | 41      | 1.78 | 45,2 |  |
| 10577-20-20      | 1-1/4  | 1-5/8x12  | 1-1/4             | 4.17 | 105,9 | 50      | 1.90 | 48,2 |  |
| 10577-32-20      | 2      | 2-1/2x12  | 1-1/4             | 4.35 | 110,5 | 2-3/4   | 2.08 | 52,8 |  |

**WARNING:** This product can expose you to chemicals including Lead, which is known to the State of California to cause cancer and birth defects or other reproductive harm. For more information go to [www.p65warnings.ca.gov](http://www.p65warnings.ca.gov).

# 1X577

## Full Flange - Code 61/62

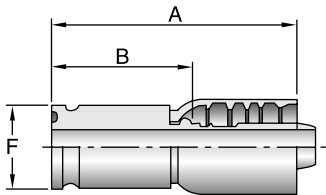

| #<br>Part Number | Flange<br>inch | Hose I.D.<br>inch | A    |       | F<br>inch | B    |      |
|------------------|----------------|-------------------|------|-------|-----------|------|------|
|                  |                |                   | inch | mm    |           | inch | mm   |
| 1X577-8-8        | 1/2            | 1/2               | 2.44 | 62,1  | 1.02      | 1.22 | 31,1 |
| 1X577-12-12      | 3/4            | 3/4               | 4.06 | 103,0 | 1.37      | 2.42 | 61,6 |
| 1X577-16-12      | 1              | 3/4               | 4.06 | 103,0 | 1.54      | 2.42 | 61,6 |
| 1X577-16-16      | 1              | 1                 | 4.45 | 113,0 | 1.54      | 2.50 | 63,5 |
| 1X577-16-20      | 1              | 1-1/4             | 4.73 | 120,2 | 1.54      | 2.46 | 62,5 |
| 1X577-20-16      | 1-1/4          | 1                 | 4.45 | 113,0 | 1.81      | 2.50 | 63,5 |
| 1X577-20-20      | 1-1/4          | 1-1/4             | 4.73 | 120,2 | 1.81      | 2.46 | 62,5 |
| 1X577-24-20      | 1-1/2          | 1-1/4             | 4.85 | 123,2 | 2.21      | 2.58 | 65,5 |
| 1X577-24-24      | 1-1/2          | 1-1/2             | 5.07 | 128,8 | 2.21      | 2.68 | 68,1 |
| 1X577-32-32      | 2              | 2                 | 6.08 | 154,4 | 2.60      | 3.32 | 84,3 |

**WARNING:** This product can expose you to chemicals including Lead, which is known to the State of California to cause cancer and birth defects or other reproductive harm. For more information go to [www.p65warnings.ca.gov](http://www.p65warnings.ca.gov).

See Accessories Section for O-Rings and Flange Kits.

**Refer to Pressure Rating of Hose End Connections Chart on page E-47.**