

14177

Female JIC 37° - Swivel - 90° Elbow - Long Drop

ISO 12151-5

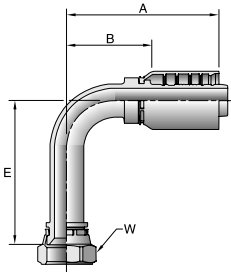

| # Part Number | Thread inch | | Hose I.D. inch | A inch mm | | E inch mm | | W mm | B inch mm | | Additional Material Stainless Steel (C) |
|------------------|----------------|-----------|-------------------|--------------|-------|--------------|-------|---------|--------------|------|--|
| 14177-8-8 | 1/2 | 3/4x16 | 1/2 | 2.78 | 70,7 | 2.52 | 64,0 | 22 | 1.56 | 39,7 | ● |
| 14177-12-12 | 3/4 | 1-1/16x12 | 3/4 | 4.24 | 107,6 | 3.78 | 96,0 | 32 | 2.60 | 66,1 | ● |
| 14177-16-16 | 1 | 1-5/16x12 | 1 | 4.72 | 119,9 | 4.49 | 114,0 | 41 | 2.77 | 70,4 | ● |

All sizes of 14177 fittings are rated at 5,000 psi working pressure.

WARNING: This product can expose you to chemicals including Lead, which is known to the State of California to cause cancer and birth defects or other reproductive harm. For more information go to www.p65warnings.ca.gov.

10577

Male SAE Thread with O-Ring - Rigid

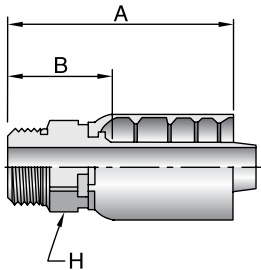

| # Part Number | Thread inch | | Hose I.D. inch | A inch mm | | H mm | B inch mm | | Additional Material Stainless Steel (C) |
|------------------|----------------|-----------|-------------------|--------------|-------|---------|--------------|------|--|
| 10577-8-8 | 1/2 | 3/4x16 | 1/2 | 2.39 | 60,8 | 22 | 1.17 | 29,8 | ● |
| 10577-12-12 | 3/4 | 1-1/16x12 | 3/4 | 3.17 | 80,5 | 32 | 1.53 | 38,9 | ● |
| 10577-16-16 | 1 | 1-5/16x12 | 1 | 3.73 | 94,7 | 41 | 1.78 | 45,2 | ● |
| 10577-20-20 | 1-1/4 | 1-5/8x12 | 1-1/4 | 4.17 | 105,9 | 50 | 1.90 | 48,2 | ● |
| 10577-32-20 | 2 | 2-1/2x12 | 1-1/4 | 4.35 | 110,5 | 2-3/4 | 2.08 | 52,8 | ● |

WARNING: This product can expose you to chemicals including Lead, which is known to the State of California to cause cancer and birth defects or other reproductive harm. For more information go to www.p65warnings.ca.gov.

1X577

Full Flange - Code 61/62

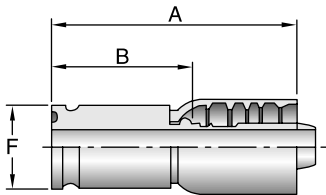

| # Part Number | Flange inch | Hose I.D. inch | A inch mm | | F inch | B inch mm | |
|------------------|----------------|-------------------|--------------|-------|-----------|--------------|------|
| 1X577-8-8 | 1/2 | 1/2 | 2.44 | 62,1 | 1.02 | 1.22 | 31,1 |
| 1X577-12-12 | 3/4 | 3/4 | 4.06 | 103,0 | 1.37 | 2.42 | 61,6 |
| 1X577-16-12 | 1 | 3/4 | 4.06 | 103,0 | 1.54 | 2.42 | 61,6 |
| 1X577-16-16 | 1 | 1 | 4.45 | 113,0 | 1.54 | 2.50 | 63,5 |
| 1X577-16-20 | 1 | 1-1/4 | 4.73 | 120,2 | 1.54 | 2.46 | 62,5 |
| 1X577-20-16 | 1-1/4 | 1 | 4.45 | 113,0 | 1.81 | 2.50 | 63,5 |
| 1X577-20-20 | 1-1/4 | 1-1/4 | 4.73 | 120,2 | 1.81 | 2.46 | 62,5 |
| 1X577-24-20 | 1-1/2 | 1-1/4 | 4.85 | 123,2 | 2.21 | 2.58 | 65,5 |
| 1X577-24-24 | 1-1/2 | 1-1/2 | 5.07 | 128,8 | 2.21 | 2.68 | 68,1 |
| 1X577-32-32 | 2 | 2 | 6.08 | 154,4 | 2.60 | 3.32 | 84,3 |

WARNING: This product can expose you to chemicals including Lead, which is known to the State of California to cause cancer and birth defects or other reproductive harm. For more information go to www.p65warnings.ca.gov.

See Accessories Section for O-Rings and Flange Kits.

Refer to Pressure Rating of Hose End Connections Chart on page E-47.